

48

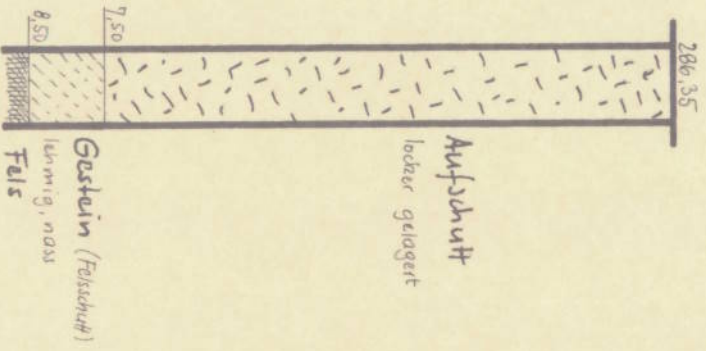

49

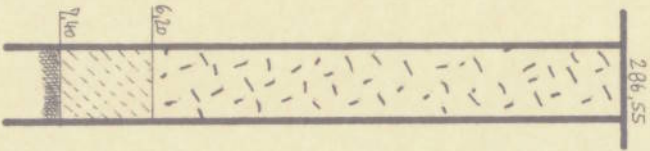

50

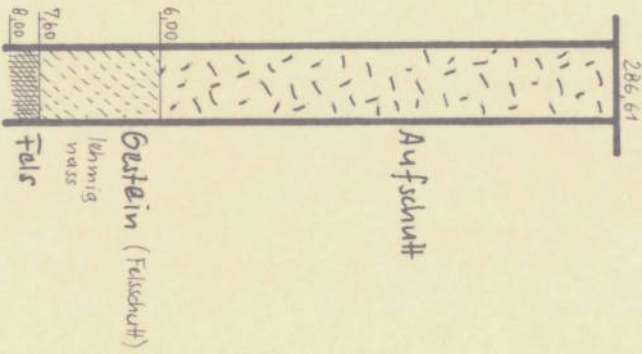

51

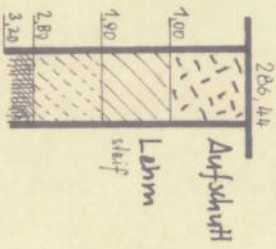

52

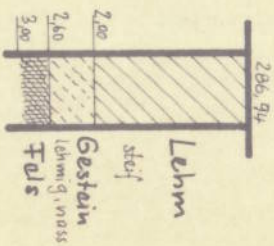

Geotechnisches Büro Bonn-Bauel	
Bauvorhaben: Grundschule - Ost	
Wermelskirchen	
Anlage	maßstab
3	1:100
Bohrprofile	datum
	11.4.74
	07.11.74
	U.

41

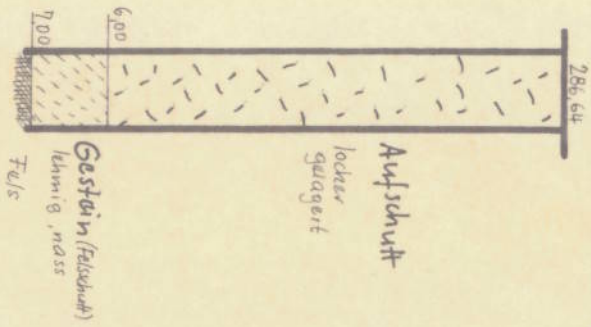

42

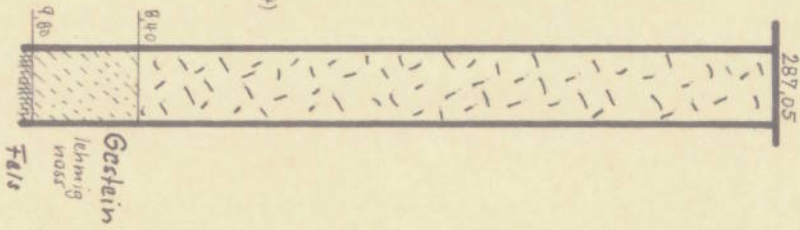

43

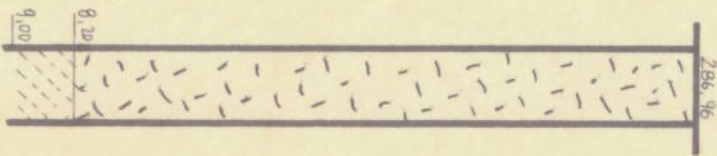

44

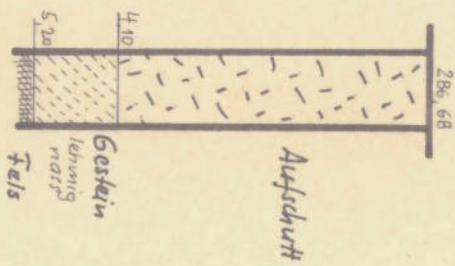

45

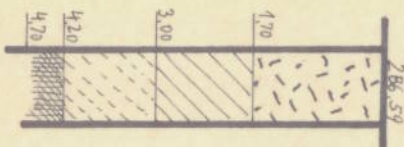

46

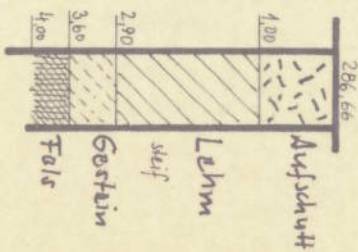

47

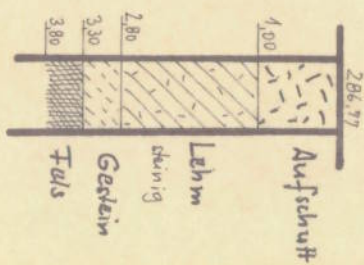

Geotechnisches Büro Bonn-Bauel			
Bauverordn.: Grundschule - Ost		Maßstab 1:100	
Wermelskirchen		Datum 11.4.71	
Anlage 2	Bohrprofile	Gez.: L.	

Geotechnisches Büro Bonn-Beuel	
Auftraggeber: Neubau Grundschule-Ost in Warmelskirchen	
Anlage 1	Lageplan d. Bohrpunkte
Datum 11.1.74	Gez. 8.
Maßstab 1:500	

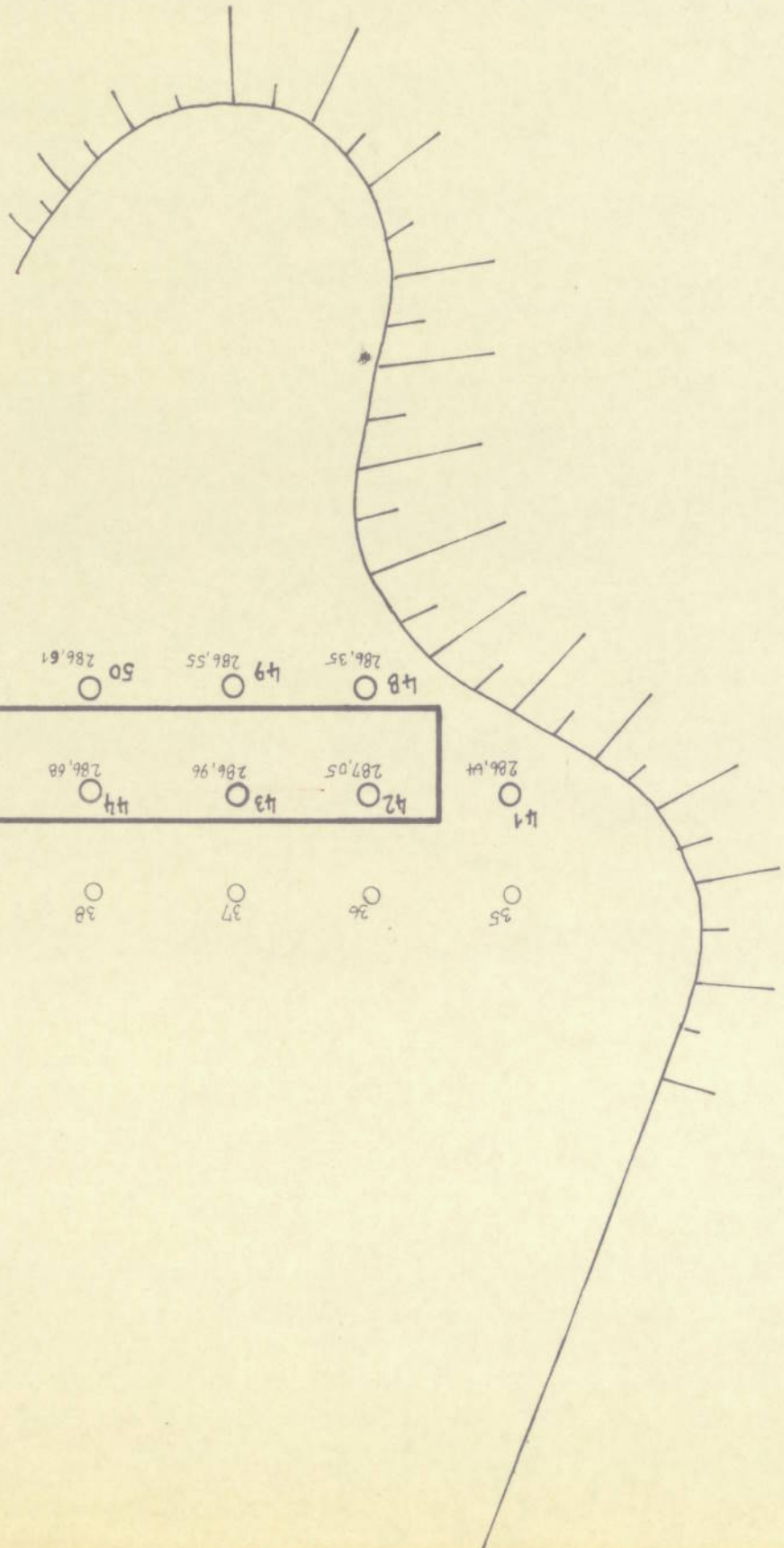

OK. vorh. Kanal
 © + 286.66